

How to order

No switch (built-in magnet for switch)

SCM-Y - LB - 40 - D - 100 - J - I

With switch (built-in magnet for switch)

SCM-Y - LB - 40 - D - 100 - T0H - D - J - I

A Mounting
*1

B Bore size

C Port thread

D Cushion

E Stroke

F Switch model No.
*3
*4

G Switch quantity

H Switch mounting

I Option
*5, *7

J Accessory
*8

⚠ Precautions for model No. selection

*1 : Mounting bracket will be shipped with the product.

*2 : Refer to page 260 for the number of installed switches and the min. stroke.

*3 : Switches other than **F** Switch model No. are also available. (Made to order)
Refer to Ending Page 1 for details.

*4 : T8H/V switches cannot be mounted when the switch mounting style is the rail.

*5 : The instantaneous max. temperature is the temperature when sparks, cutting chips, etc., instantaneously contact the bellows.

*6 : Refer to Ending Page 85 for custom specifications of rod end form.

*7 : "Q" (switch rail enclosed at shipment) is not available for the "Z" switch mounting.

*8 : "I" and "Y" cannot be selected together.

*9 : Switches are shipped with the product. Contact CKD if assembling before shipment is necessary.

[Example of model No.]

SCM-Y-LB-40D-100-T0H-D-JI

Model: Round shaped cylinder, single acting/pull

- A** Mounting : Axial foot
- B** Bore size : ø40 mm
- C** Port thread : Rc thread
- D** Cushion : With two-sided rubber cushion
- E** Stroke : 100 mm
- F** Switch model No. : Reed T0H switch, lead wire 1 m
- G** Switch quantity : 2
- H** Switch mounting : Rail
- I** Option : Bellows material/max. ambient temperature 100°C
- J** Accessory : Rod eye

How to order mounting bracket

Bore size (mm)	ø20	ø25	ø32	ø40
Mounting bracket				
Foot (LB)	SCM-LB-20	SCM-LB-25	SCM-LB-32	SCM-LB-40
Flange (FA/FB)	SCM-FA-20	SCM-FA-25	SCM-FA-32	SCM-FA-40
Eye bracket (CA)	SCM-CA-20	SCM-CA-25	SCM-CA-32	SCM-CA-40
Trunnion (TA/TB)	SCM-TA-20	SCM-TA-25	SCM-TA-32	SCM-TA-40

*1: All mounting brackets are supplied with mounting bolts.

*2: The foot mounting bracket is provided as 2 pcs./set.

Code	Description
A Mounting	
00	Basic
LB	Axial foot
FA	Rod side flange
FB	Head side flange
CA	Eye bracket
TA	Rod side trunnion
TB	Head side trunnion

B Bore size (mm)	
20	ø20
25	ø25
32	ø32
40	ø40

C Port thread	
Blank	Rc thread
N	NPT thread (made-to-order product)
G	G thread (made-to-order product)

D Cushion	
D	With two-sided rubber cushion

E Stroke (mm)		
Bore size	Stroke *2	Custom stroke
ø20 to ø40	5 to 200	In 1 mm increments

Axial lead wire		Radial lead wire		Contact	Voltage		Indicator	Lead wire
					AC	DC		
T0H*	T0V*	T5H*	T5V*	Reed	●	●	1-color LED	2-wire
T5H*	T5V*	T8H*	T8V*		●	●	No indicator lamp	
T8H*	T8V*	T1H*	T1V*		●	●	1-color LED	
T1H*	T1V*	T2H*	T2V*	Proximity	●	●	1-color LED	2-wire
T2H*	T2V*	T3H*	T3V*		●	●	1-color LED	3-wire
T3H*	T3V*	T3PH*	T3PV*		●	●	1-color LED	3-wire
T3PH*	T3PV*	T2WH*	T2WV*		●	●	2-color LED	2-wire
T2WH*	T2WV*	T2YH*	T2YV*		●	●		3-wire
T2YH*	T2YV*	T3WH*	T3WV*		●	●	2-color LED for AC magnetic field	2-wire
T3WH*	T3WV*	T3YH*	T3YV*		●	●		2-wire
T3YH*	T3YV*	T2YD*	-		●	●	1-color LED off-delay	2-wire
T2YD*	-	T2YDT*	-		●	●		
T2YDT*	-	T2JH*	T2JV*		●	●		
T2JH*	T2JV*							

* Lead wire length	
Blank	1 m (standard)
3	3 m (option)
5	5 m (option)

G Switch quantity	
R	1 on rod side
H	1 on head side
D	2
T	3
4	4 (when there are more than 4 switches, indicate switch quantity.)

H Switch mounting	
Blank	Rail method
Z	Band method

I Option	
	Max. ambient temp. ; instantaneous max. temp.
J	Bellows material, 100°C ; 200°C
L	Bellows material, 250°C ; 400°C
Q	Switch rail included at shipment
M	Piston rod material (stainless steel)
P6	Copper and PTFE free

J Accessory	
I	Rod eye
Y	Rod clevis (pin and snap ring included)
B2	Clevis bracket

How to order switch

[Switch mounting: Rail]

● Switch body + mounting rail set

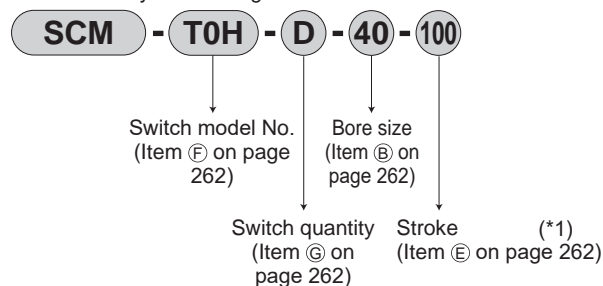

● Mounting rail only

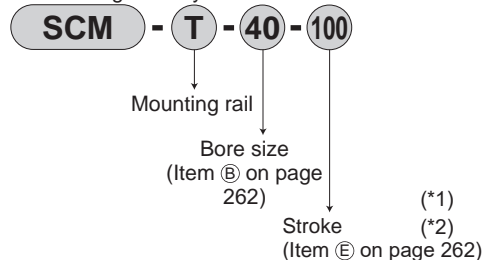

*1: Indicate X if the stroke exceeds 300 mm.
If exceeding 300 mm, a short rail (with 100 mm switch adjustment length) will be included per switch.

*2: If indicating X when ordering mounting rails only, order the same number of rails as that of applicable switches.

[Switch mounting: Band]

● Switch body + mounting bracket set + band

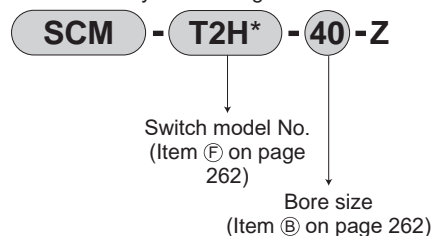

● Mounting bracket set + band

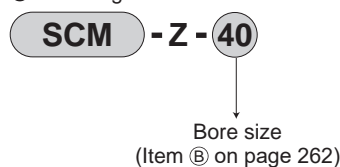

[Switch body only]

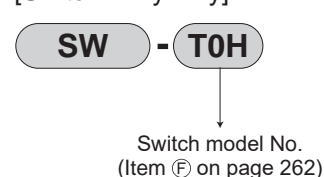

Theoretical thrust table

(Unit: N)

Bore size (mm)	Working pressure MPa								
	0.2	0.3	0.4	0.5	0.6	0.7	0.8	0.9	1.0
ø20	15	41	68	94	1.20x10 ²	1.47x10 ²	1.73x10 ²	2.00x10 ²	2.26x10 ²
ø25	42	84	1.25x10 ²	1.66x10 ²	2.07x10 ²	2.48x10 ²	2.90x10 ²	3.31x10 ²	3.72x10 ²
ø32	83	1.52x10 ²	2.22x10 ²	2.91x10 ²	3.60x10 ²	4.29x10 ²	4.98x10 ²	5.67x10 ²	6.36x10 ²
ø40	1.11x10 ²	2.17x10 ²	3.22x10 ²	4.28x10 ²	5.33x10 ²	6.39x10 ²	7.44x10 ²	8.50x10 ²	9.56x10 ²

Note: The load above indicates thrust excluding the spring force at the pull end.

Internal structure and parts list

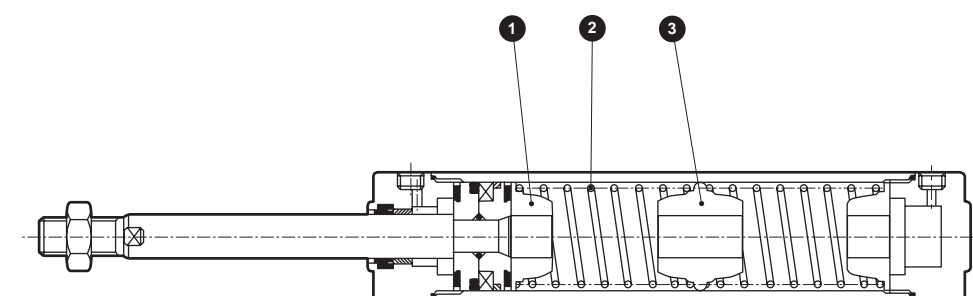

Repair parts list

Numbering of repair parts follows that in the internal structure of the SCM Series (page 236).

No.	Part name	Material	Remarks
1	Spring holder A	Aluminum alloy	
2	Coil spring	Piano wire	Electrodeposition
3	Spring holder B	Aluminum alloy	

Parts other than the above are the same as the double acting.

Bore size (mm)	Kit No.	Repair parts No.
ø20	SCM-Y-20DK	3 6 8 10 13
ø25	SCM-Y-25DK	
ø32	SCM-Y-32DK	
ø40	SCM-Y-40DK	